

214 E Lachapelle  
San Antonio TX 78204

Zoning from: R6  
Zoning to: IDZ2 – 3 story single family residence w/ 2 car garage

Legal Description of the Land:  
The East 14 feet of Lot 8 and the West 16 feet of Lot 9, Block 3, NCB 2582, in the City of San Antonio, Bexar County, Texas.

0.0237 ACRES of open space

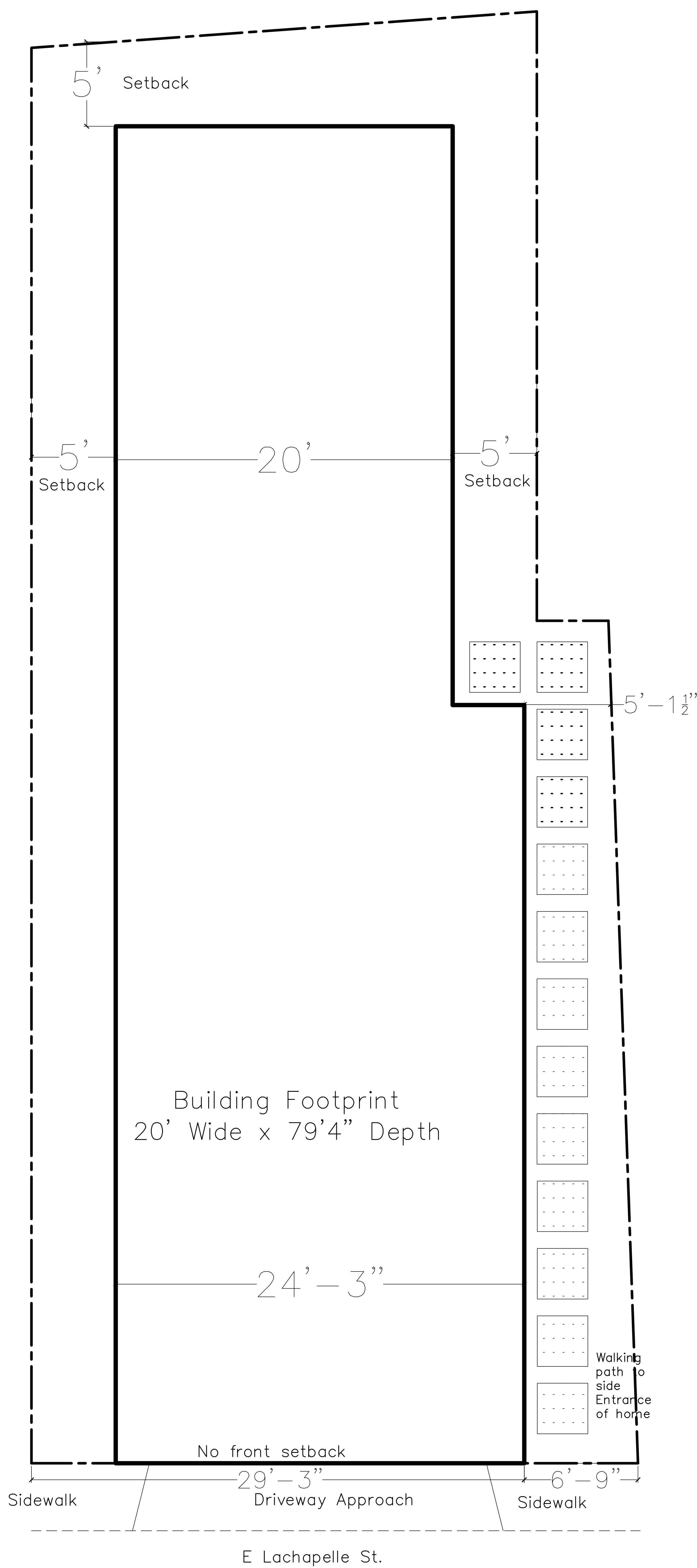

Z-2023-10700005

From: "R-6 AHOD" Residential Single-Family Airport Hazard Overlay District  
To: "IDZ-2 AHOD" Medium Intensity Infill Development Zone Airport Hazard Overlay District  
with uses permitted for one (1) dwelling unit

Density proposed: 1 single-family dwelling proposed

Landscaping: Open space may be utilized for landscaping

Parking: 2 spaces provided, 9' x 18'

Square footage: 3800 sq/ft

“I, Jagath Santha, owner of JS7 Investments, the property owner, acknowledge that this site plan submitted for the purpose of rezoning this property is in accordance with all applicable provisions of the Unified Development Code. Additionally, I understand that City Council approval of a site plan in conjunction with a rezoning case does not relieve me from adherence to any/all City adopted Code at the time of plan submittal for building permits.”